

LOCULO APERTURA LATERALE

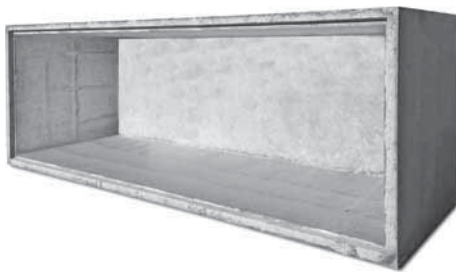

CODICE	DESCRIZIONE	DIMENSIONI ESTERNE CM.	DIMENSIONI INTERNE CM.	PESO KG.
LOCL	Loculo apertura laterale	240x85,5x80h	230x77,5x70h	826
LASLOC	Lastra chiusura loculo laterale		71x76,5	33

SEZIONE FRONTALE

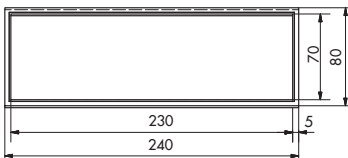

SEZIONE LATERALE

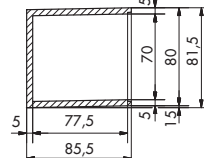

SCHEMA DI MONTAGGIO
(composizione massima 5 posti)

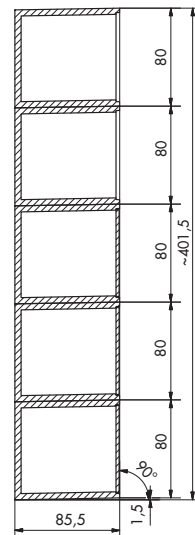

PIANTA

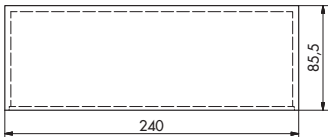

PIASTRA DI CHIUSURA

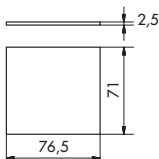

I loculi dovranno essere posati con un'inclinazione di 1,5 cm verso l'interno

LOCULO APERTURA FRONTALE

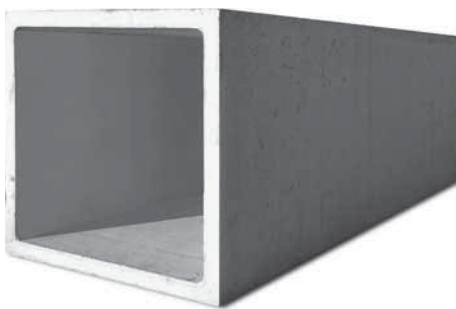

CODICE	DESCRIZIONE	DIMENSIONI ESTERNE CM.	DIMENSIONI INTERNE CM.	PESO KG.
LOCULI	Loculo apertura frontale	240x85x80h	235x75x70h	959
LSTLOC	Lastrine loculo frontale		74,5x69,5	38

SEZIONE FRONTALE

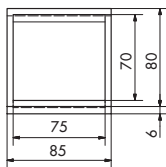

SEZIONE LATERALE

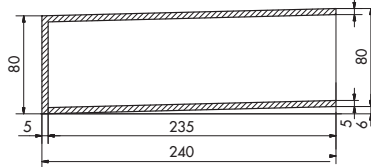

PIASTRA DI CHIUSURA

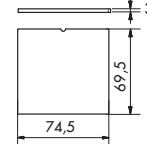

PIANTA

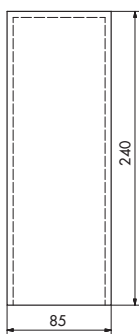

SCHEMA DI MONTAGGIO
(composizione massima 6 posti)

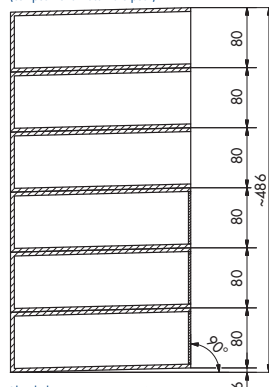

I loculi dovranno essere posati con un'inclinazione di 6 cm verso l'interno